

MACHEREY-NAGEL

User manual

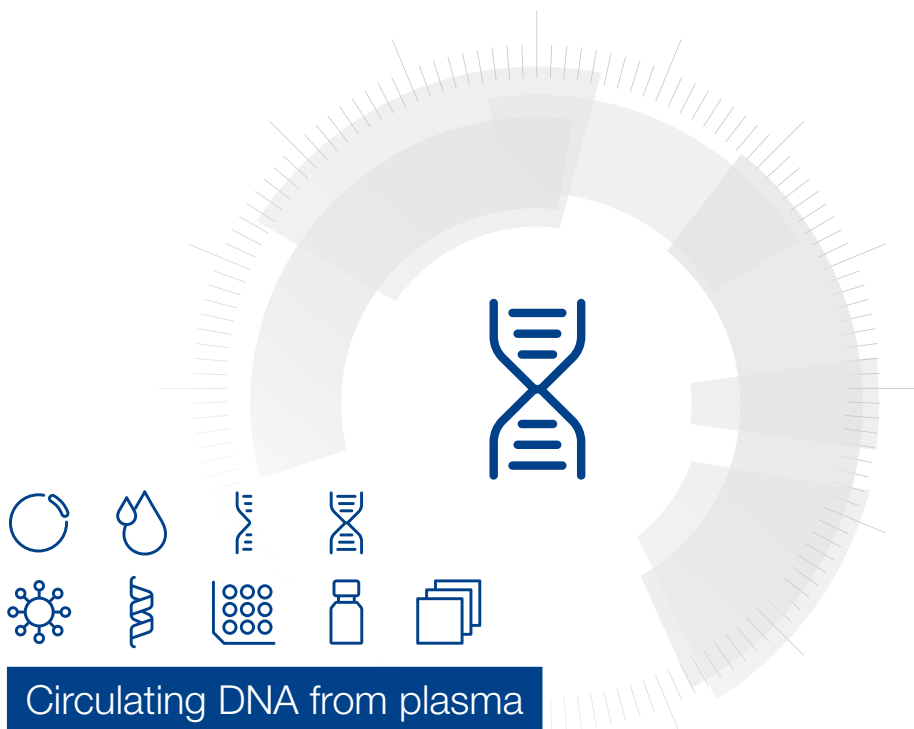

- NucleoSpin® 96 cfDNA
- NucleoSpin® 96 cfDNA Core Kit

November 2021 / Rev. 04

Contact MN

Germany and international

MACHEREY-NAGEL GmbH & Co. KG
Valenciener Str. 11 · 52355 Düren · Germany
Tel.: +49 24 21 969-0
Toll-free: 0800 26 16 000 (Germany only)
E-mail: info@mn-net.com

Technical Support Bioanalysis

Tel.: +49 24 21 969-270
E-mail: tech-bio@mn-net.com

USA

MACHEREY-NAGEL Inc.
924 Marcon Blvd. · Suite 102 · Allentown PA, 18109 · USA
Toll-free: 888 321 6224 (MACH)
E-mail: sales-us@mn-net.com

France

MACHEREY-NAGEL SAS
1, rue Gutenberg – BP135 · 67720 Hoerdt Cedex · France
Tel.: +33 388 68 22 68
E-mail: sales-fr@mn-net.com

MACHEREY-NAGEL SAS (Société par Actions Simplifiée) au capital de 186600 €
Siret 379 859 531 00020 · RCS Strasbourg B379859531 · N° intracommunautaire FR04 379 859 531

Switzerland

MACHEREY-NAGEL AG
Hirsackerstr. 7 · 4702 Oensingen · Switzerland
Tel.: +41 62 388 55 00
E-mail: sales-ch@mn-net.com

Table of contents

1	Components	4
1.1	Kit contents	4
1.2	Reagents, consumables, and equipment to be supplied by user	5
1.3	About this user manual	6
2	Product description	7
2.1	The basic principle	7
2.2	Kit specifications	7
2.3	Size and yield of DNA from plasma	8
2.4	Handling of sample material	8
2.5	Elution procedures	8
2.6	Stability of isolated DNA	8
3	Storage conditions and preparation of working solutions	9
4	Safety instructions	10
5	Protocol for the isolation of DNA from plasma	11
6	Appendix	15
6.1	Troubleshooting	15
6.2	Ordering information	16
6.3	Product use restriction/warranty	16

1 Components

1.1 Kit contents

NucleoSpin® 96 cfDNA		
REF	1 x 96 preps 740873.1	4 x 96 preps 740873.4
Activation Buffer PMA	75 mL	2 x 100 mL
Lysis Buffer PML	100 mL	4 x 100 mL
Binding Buffer PMB	2 x 250 mL	8 x 250 mL
Wash Buffer PMW1	100 mL	500 mL
Wash Buffer PMW2 (Concentrate) *	50 mL	2 x 100 mL
Elution Buffer PME **	13 mL	60 mL
Liquid Proteinase K	6 mL	4 x 6 mL
NucleoSpin® cfDNA Binding Plate (red rings)	1	4
MN Wash Plate	1	4
Square-well Block (96 wells)	2	8
Round-well Block with Cap Strips	1	4
User manual	1	1

* For preparation of working solutions and storage conditions see section 3

** Elution Buffer PME: 5 mM Tris/HCl, pH 8.5

NucleoSpin® 96 cfDNA Core Kit		
REF	1 x 96 preps 740874.1	4 x 96 preps 740874.4
Activation Buffer PMA	75 mL	2 x 100 mL
Lysis Buffer PML	100 mL	4 x 100 mL
Binding Buffer PMB	2 x 250 mL	8 x 250 mL
Wash Buffer PMW1	100 mL	500 mL
Wash Buffer PMW2 (Concentrate) *	50 mL	2 x 100 mL
Elution Buffer PME	13 mL	60 mL
Liquid Proteinase K	6 mL	4 x 6mL
NucleoSpin® cfDNA Binding Plate	1	4
User manual	1	1

1.2 Reagents, consumables, and equipment to be supplied by user

Reagents:

- 96–100 % ethanol

Consumables:

- For lysis and adjusting of binding conditions: 1 x 96 Square-well Block for processing 500 µL samples, 2 x 96 Square-well Blocks for processing 1 mL samples, 4 x 96 Square-well Blocks for processing 2 mL samples.
- Disposable pipette tips

Equipment:

- NucleoVac 96 Vacuum Manifold (see ordering information section 6.2)
- NucleoVac Vacuum Regulator (see ordering information section 6.2)
- Vacuum pump
- Heater-shaker or incubator oven
- Multi channel pipettes or large volume pipettes with appropriate tips
- Personal protection equipment (lab coat, gloves, goggles)

* For preparation of working solutions and storage conditions see section 3

** Elution Buffer PME: 5 mM Tris/HCl, pH 8.5

1.3 About this user manual

It is strongly recommended for first time users to read the detailed protocol sections of the **NucleoSpin® 96 cfDNA** kit before using this product. Experienced users, however, may refer to the Protocol at a glance instead. The Protocol at a glance is designed to be used only as a supplemental tool for quick referencing while performing the purification procedure.

All technical literature is available online at ***www.mn-net.com***.

2 Product description

2.1 The basic principle

The **NucleoSpin® 96 cfDNA** kit is designed for the efficient isolation of circulating DNA from human blood plasma. Fragmented DNA of 50 bp and larger can be purified with high efficiency. The **NucleoSpin® 96 cfDNA** kit can be used with manual and automated vacuum manifolds. The kit is fully automatable on many liquid handling robots.

The protocol follows state-of-the-art bind-wash-elute procedures: lysis is performed within 30 minutes with Proteinase K and lysis buffer. Afterwards, a binding buffer is added and the solution is applied onto the wells of the binding plate in several steps and DNA is bound to the silica membrane. Three washing steps efficiently remove contaminating substances, such as PCR inhibitors. Drying of silica is achieved by applying vacuum or positive pressure and pure DNA is finally eluted.

2.2 Kit specifications

- The **NucleoSpin® 96 cfDNA** kit is recommended for the isolation of circulating cell-free DNA from human plasma.
- The **NucleoSpin® 96 cfDNA** kit is designed for high recovery of fragmented DNA ≥ 50 bp.
- Up to 2 mL plasma can be used as sample material in a single well
- DNA yield strongly depends on the individual sample, but is typically in the range of 0.1 to 100 ng DNA per mL plasma.
- DNA is ready to use for downstream applications such as real-time PCR or NGS.
- The preparation time is approximately 90 min for up to 96 plasma samples.

Kit specifications at a glance

Parameter	NucleoSpin® 96 cfDNA
Technology	Silica-membrane technology
Format	96-well plates
Processing	Manual and automated, vacuum or positive pressure
Sample material	Human EDTA / Cell-Free DNA BCT® (Streck) plasma
Sample amount	0.5–2 mL per preparation
Typical yield	sample dependent
Elution volume	100 μ L (recovered volume about 70 μ L)
Preparation time	approx. 90 min / 96 preps

2.3 Size and yield of DNA from plasma

Usually, DNA concentrations in plasma are in a range of 0.1 ng up to several 100 ng DNA per mL of plasma. The amount of circulating DNA in plasma depends on health condition of the donor, sampling and handling of the blood, plasma preparation, DNA isolation method, and others.

A significant portion of the cell-free DNA in plasma originates from apoptotic cells. Therefore, a considerable percentage of this circulating DNA is known to be highly fragmented. However, the degree of fragmentation and the ratio of fragmented DNA to high molecular weight DNA depends on several parameters like origin of the DNA (e.g., fetal, tumor, microbial DNA), health condition of the blood donor, blood sampling procedure, and handling of the sample.

2.4 Handling of sample material

Circulating DNA yield and quality is largely influenced by blood sampling technique, handling, storage, and plasma preparation. It is highly recommended to perform these steps as uniform as possible in order to achieve highest reproducibility.

Plasma can be isolated according to the following recommendation:

Preparation of plasma from human EDTA blood or Streck Cell-Free DNA BCT®

- 1 Centrifuge samples for 10 min at 2,000 x *g*.
- 2 Remove the plasma without disturbing sedimented cells and particles.
- 3 Clear plasma of residual cellular debris by means of centrifugation (10 min at 5000 x *g*).
- 4 If necessary, freeze plasma samples in fresh tubes. Upon thawing, check for precipitates and remove them with a final centrifugation step.

2.5 Elution procedures

The recommended standard elution procedure comprises two steps of 50 µL. This will result in about 70 µL eluate. The retained volume will contain very little amounts of DNA because the majority will be present in the eluted fraction.

2.6 Stability of isolated DNA

Due to the low DNA content in plasma and the resulting low total amount of isolated DNA, its fragmentation, and the absence of DNase inhibitors (the elution buffer does NOT contain EDTA), the eluates should be kept on ice for short term storage and frozen at -20 °C for long term storage.

3 Storage conditions and preparation of working solutions

Attention: Buffers PML, PMB and PMW1 contain guanidinium hydrochloride (chaotropic salt) which can form highly reactive compounds when combined with bleach (sodium hypochlorite). DO NOT add bleach or acidic solutions directly to the sample-preparation waste. Wear gloves and goggles!

Storage conditions:

- All kit components can be stored at 15–25 °C and are stable for at least one year.
- If there is any precipitate present in the buffers, warm the buffer up to 25–37 °C to dissolve the precipitate before use.

Before starting any **NucleoSpin® 96 cfDNA** protocol, prepare the following:

- **Wash Buffer PMW2:** Ethanol has to be added to Wash Buffer PMW2 (Concentrate) according to the instructions on the label and in this user manual. Mark the label of the bottle to indicate that ethanol was added. All other kit components are ready to use.
- Prepare plasma sample according to section 2.4.
- Set heating block or incubator oven to 56 °C for lysis.
- Set up the **NucleoVac 96 Vacuum Manifold**.
- **Liquid Proteinase K** is ready to use. After first opening, store Liquid Proteinase K at 4 °C or -20 °C
- When using multi well plates, samples have to be split into suitable aliquots.

NucleoSpin® 96 cfDNA

REF	1 x 96 preps 740873.1	4 x 96 preps 740873.4
Buffer PMW2 (Concentrate)	50 mL Add 200 mL ethanol	2 x 100 mL Add 400 mL ethanol to each bottle

NucleoSpin® 96 cfDNA Core Kit

REF	1 x 96 preps 740874.1	4 x 96 preps 740874.4
Buffer PMW2 (Concentrate)	50 mL Add 200 mL ethanol	2 x 100 mL Add 400 mL ethanol to each bottle

4 Safety instructions

When working with the **NucleoSpin® 96 cfDNA** and **NucleoSpin® 96 cfDNA Core Kit** kit wear suitable protective clothing (e.g., lab coat, disposable gloves, and protective goggles). For more information consult the appropriate Material Safety Data Sheets (MSDS available online at www.mn-net.com/msds).



4.1 Disposal

Dispose hazardous, infectious or biologically contaminated materials in a safe and acceptable manner and in accordance with all local and regulatory requirements.

5 Protocol for the isolation of DNA from plasma

Protocol at a glance

1 Lyse samples	25 µL Proteinase K
	1 mL plasma
	Mix
	400 µL Buffer PML
	Mix
	Incubate at 56 °C, 30 min
	<i>Note: For Streck Cell-Free DNA BCT® incubate 60 min</i>

Prepare the NucleoVac 96 Vacuum Manifold

	400 µL Buffer PMA per well
	-0.4 bar*, 1 min
2 Adjust DNA binding conditions	2 mL Buffer PMB
	Mix
3 Bind DNA	Transfer lysates
	<i>Note: Transfer lysates in aliquots of 1 mL</i>
	-0.4 bar*, 2 min
4 Wash silica membrane	800 µL PMW1
	-0.4 bar*, 2 min
	1 mL PMW2
	-0.4 bar*, 2 min
	1 mL PMW2
	-0.4 bar*, 2 min
5 Dry silica membrane	-0.6 bar*, 10 min

* Reduction of atmospheric pressure

6 Elute DNA

50 µL PME

Incubate 1 min at RT

**-0.4 bar*,
30 s**

50 µL PME

**-0.6 bar*,
30 s**

Setup of vacuum manifold:

Binding / Washing steps

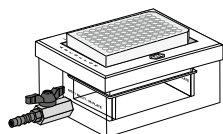
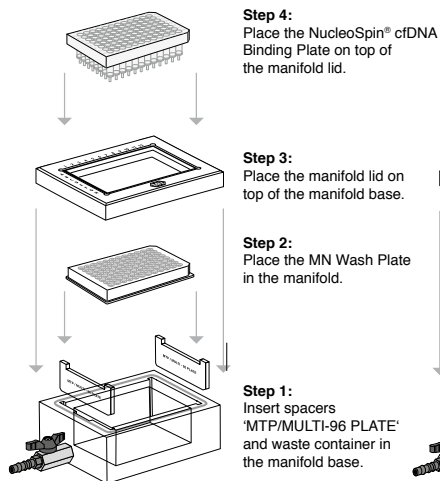

Final setup

Elution step

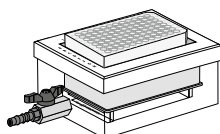
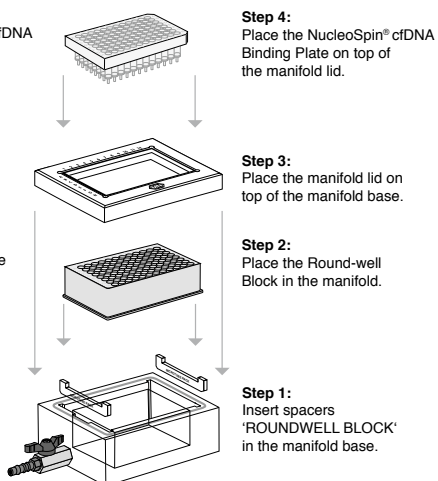

Final setup

* Reduction of atmospheric pressure

5.1 Detailed protocol

The procedure below describes the isolation of cell-free DNA from 1 mL human plasma. Adjusting reagent volumes according to the table below allows for processing of plasma volumes from 0.5–2 mL.

Plasma volume [mL]	Liquid Proteinase K [µL]	Lysis Buffer PML [µL]	Binding Buffer PMB [mL]
0.5	12.5	200	1
1	25	400	2
2	50	800	4

1 Lyse sample

Add **25 µL Liquid Proteinase K** to each well of a 24-Square-well block. (Alternatively, samples can be split into aliquots of 500 µL and processed in 96 Square-well Blocks.)

Add **1 mL plasma** and **mix** by pipetting.

Add **400 µL Buffer PML** and **mix** by pipetting.

Incubate at **56 °C for 30 min** (For Streck Cell-Free DNA BCT®, incubate 60 min; ideally with shaking).

Prepare the NucleoVac 96 Vacuum manifold

Insert spacers 'MTP/MULTI-96 PLATE', the Waste Container and the Wash Plate into the manifold base. Place the manifold lid on top and then the **NucleoSpin® cfDNA Binding Plate**.

While incubating the lysis, apply **400 µL Buffer PMA** to the wells of the NucleoSpin® cfDNA Binding Plate. Incubate one minute, then apply vacuum of **-0.4 bar*** for **1 min**.

2 Adjust binding conditions

Add **2 mL Buffer PMB** to each well and mix by pipetting.

3 Bind DNA

Transfer prepared lysates to the NucleoSpin® cfDNA Binding Plate in aliquots of 1 mL.

Apply vacuum of **-0.4 bar*** for **2 min**.

Lysates can be loaded continuously while they are passing the membrane. Remove, empty and replace Waste Container after the third loading step as well as after column loading is completed.

* Reduction of atmospheric pressure

4 Wash silica membrane

1st wash

Once all lysates have passed the membrane, add **800 µL Buffer PMW1** to each well. Incubate for **1 min**, and then apply vacuum of **-0.4 bar*** for **2 min**.

2nd wash

Add 1 mL **Buffer PMW2**, and then apply vacuum of **-0.4 bar*** for **2 min**.

3rd wash

Repeat 2nd wash step.

Remove and empty Waste Container. Remove Wash Plate.

5 Dry silica membrane

Apply strongest possible vacuum of at least **-0.6 bar*** for **10 min** to dry the silica membrane.

After drying, blot column outlets on tissue paper to remove residual ethanol.

Insert spacers "ROUNDWELL Block" and place a Round-well Block on top. Place the manifold lid on top and then the **NucleoSpin® cfDNA Binding Plate**.

6 Elute highly pure DNA

Add **50 µL Buffer PME** (first elution step) to the membrane. Incubate **1 min**.

Apply vacuum of **-0.4 bar*** for **30 s**.

Add **50 µL Buffer PME** (second elution step) to the membrane.

Apply vacuum of **-0.6 bar*** for **30 s**.

Spin eluates down and cover elution plate.

* Reduction of atmospheric pressure

6 Appendix

6.1 Troubleshooting

Problem	Possible cause and suggestions
Low DNA yield	<p><i>Low DNA content of the sample</i></p> <ul style="list-style-type: none"> The content of cell-free DNA in human plasma may vary over several orders of magnitude. DNA contents in the range of 0.1–1000 ng DNA per mL of plasma have been reported (see remarks in section 2.3). If the DNA concentration is measured with double strand specific dyes, e.g., PicoGreen®, make sure not to heat the DNA before measurement. Due to denaturation of DNA during the heat incubation step and the double strand specificity of certain DNA dyes, e.g., PicoGreen®, results may be inaccurate.
	<p><i>Sample contains residual cell debris or cells</i></p> <ul style="list-style-type: none"> The plasma sample may have contained residual cells or cell debris. Make sure to use only clear plasma samples (see remarks in section 2.4).
Discrepancy between A_{260} quantification values and PCR quantification values	<p><i>Silica abrasion from the membrane</i></p> <ul style="list-style-type: none"> Due to the typically low DNA content in plasma and the resulting low total amount of isolated DNA, DNA quantification via A_{260} absorption measurement is often hampered due to the low sensitivity of the absorption measurement. When performing absorption measurements close to the detection limit of the photometer, the measurement may be influenced by minor amounts of silica abrasion. In order to prevent incorrect A_{260}-quantification of small DNA amounts, centrifuge the eluate for 30 s at $> 11.000 \times g$ and take an aliquot for measurement without disturbing any sediment. Alternatively, use a silica abrasion insensitive DNA quantification method (e.g., PicoGreen® fluorescent dye).
	<p><i>Measurement not in the range of photometer detection limit</i></p> <ul style="list-style-type: none"> In order to obtain a significant A_{260}/A_{280} ratio, it is necessary that the initially measured A_{260} and A_{280} values are significantly above the detection limit of the photometer used. An A_{280} value close to the background noise of the photometer will cause unexpected A_{260}/A_{280} ratios.

6.2 Ordering information

Product	REF	Pack of
NucleoSpin® 96 cfDNA	740873.1	1
	740873.4	4
NucleoSpin® 96 cfDNA Core Kit	740874.1	1
	740874.4	4
Square-well Block (96 wells)	740481	4
	740481.24	24
Round-well Block with Cap-strips	740475	4
	740475.24	24
Lysis Buffer PML	740835.125	125 mL
Binding Buffer PMB	740836.250	250 mL
Liquid Proteinase K	740396	5 mL
NucleoVac 96 Vacuum Manifold	740681	1
NucleoVac Vacuum Regulator	740641	1

Note: The product has been formerly distributed under the name NucleoSpin® 96 DNA Plasma. The product code (REF) and kit content have not been changed.

6.3 Product use restriction/warranty

NucleoSpin® 96 cfDNA kit components are intended, developed, designed, and sold FOR RESEARCH PURPOSES ONLY, except, however, any other function of the product being expressly described in original MACHEREY-NAGEL product leaflets.

MACHEREY-NAGEL products are intended for GENERAL LABORATORY USE ONLY! MACHEREY-NAGEL products are suited for QUALIFIED PERSONNEL ONLY! MACHEREY-NAGEL products shall in any event only be used wearing adequate PROTECTIVE CLOTHING. For detailed information please refer to the respective Material Safety Data Sheet of the product! MACHEREY-NAGEL products shall exclusively be used in an ADEQUATE TEST ENVIRONMENT. MACHEREY-NAGEL does not assume any responsibility for damages due to improper application of our products in other fields of application. Application on the human body is STRICTLY FORBIDDEN. The respective user is liable for any and all damages resulting from such application.

DNA/RNA/PROTEIN purification products of MACHEREY-NAGEL are suitable for IN VITRO-USES ONLY!

ONLY MACHEREY-NAGEL products specially labeled as IVD are also suitable for IN VITRO-diagnostic use. Please pay attention to the package of the product. IN VITRO-diagnostic products are expressly marked as IVD on the packaging.

IF THERE IS NO IVD SIGN, THE PRODUCT SHALL NOT BE SUITABLE FOR IN VITRO-DIAGNOSTIC USE!

ALL OTHER PRODUCTS NOT LABELED AS IVD ARE NOT SUITED FOR ANY CLINICAL USE (INCLUDING, BUT NOT LIMITED TO DIAGNOSTIC, THERAPEUTIC AND/OR PROGNOSTIC USE).

No claim or representations is intended for its use to identify any specific organism or for clinical use (included, but not limited to diagnostic, prognostic, therapeutic, or blood banking). It is rather in the responsibility of the user or - in any case of resale of the products - in the responsibility of the reseller to inspect and assure the use of the DNA/RNA/protein purification products of MACHEREY-NAGEL for a well-defined and specific application.

MACHEREY-NAGEL shall only be responsible for the product specifications and the performance range of MN products according to the specifications of in-house quality control, product documentation and marketing material.

This MACHEREY-NAGEL product is shipped with documentation stating specifications and other technical information. MACHEREY-NAGEL warrants to meet the stated specifications. MACHEREY-NAGEL's sole obligation and the customer's sole remedy is limited to replacement of products free of charge in the event products fail to perform as warranted. Supplementary reference is made to the general business terms and conditions of MACHEREY-NAGEL, which are printed on the price list. Please contact us if you wish to get an extra copy.

There is no warranty for and MACHEREY-NAGEL is not liable for damages or defects arising in shipping and handling (transport insurance for customers excluded), or out of accident or improper or abnormal use of this product; defects in products or components not manufactured by MACHEREY-NAGEL, or damages resulting from such non-MACHEREY-NAGEL components or products.

MACHEREY-NAGEL makes no other warranty of any kind whatsoever, and SPECIFICALLY DISCLAIMS AND EXCLUDES ALL OTHER WARRANTIES OF ANY KIND OR NATURE WHATSOEVER, DIRECTLY OR INDIRECTLY, EXPRESS OR IMPLIED, INCLUDING, WITHOUT LIMITATION, AS TO THE SUITABILITY, REPRODUCTIVITY, DURABILITY, FITNESS FOR A PARTICULAR PURPOSE OR USE, MERCHANTABILITY, CONDITION, OR ANY OTHER MATTER WITH RESPECT TO MACHEREY-NAGEL PRODUCTS.

In no event shall MACHEREY-NAGEL be liable for claims for any other damages, whether direct, indirect, incidental, compensatory, foreseeable, consequential, or special (including but not limited to loss of use, revenue or profit), whether based upon warranty, contract, tort (including negligence) or strict liability arising in connection with the sale or the failure of MACHEREY-NAGEL products to perform in accordance with the stated specifications. This warranty is exclusive and MACHEREY-NAGEL makes no other warranty expressed or implied.

The warranty provided herein and the data, specifications and descriptions of this MACHEREY-NAGEL product appearing in MACHEREY-NAGEL published catalogues and product literature are MACHEREY-NAGEL's sole representations concerning the product and warranty. No other statements or representations, written or oral, by

MACHEREY-NAGEL´s employees, agent or representatives, except written statements signed by a duly authorized officer of MACHEREY-NAGEL are authorized; they should not be relied upon by the customer and are not a part of the contract of sale or of this warranty.

Product claims are subject to change. Therefore please contact our Technical Service Team for the most up-to-date information on MACHEREY-NAGEL products. You may also contact your local distributor for general scientific information. Applications mentioned in MACHEREY-NAGEL literature are provided for informational purposes only. MACHEREY-NAGEL does not warrant that all applications have been tested in MACHEREY-NAGEL laboratories using MACHEREY-NAGEL products. MACHEREY-NAGEL does not warrant the correctness of any of those applications.

Last updated: 07/2010, Rev. 03

Please contact:
MACHEREY-NAGEL GmbH & Co. KG
Tel.: +49 24 21 969-270
tech-bio@mn-net.com

Trademarks/Disclaimer:

Cell-Free DNA BCT is a registered trademark of Streck, Inc.
NucleoSpin is a registered trademark of MACHEREY-NAGEL GmbH & Co. KG
Picogreen is a registered trademark of Molecular Probes, Inc.

All used names and denotations can be brands, trademarks, or registered labels of their respective owner – also if they are not special denotation. To mention products and brands is only a kind of information (i.e., it does not offend against trademarks and brands and can not be seen as a kind of recommendation or assessment). Regarding these products or services we can not grant any guarantees regarding selection, efficiency, or operation.

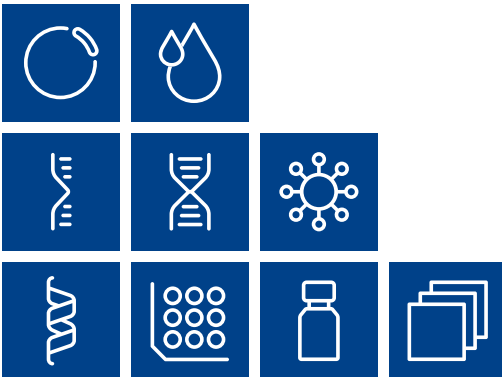

Plasmid DNA
Clean up
RNA
DNA
Viral RNA and DNA
Protein
High throughput
Accessories
Auxiliary tools

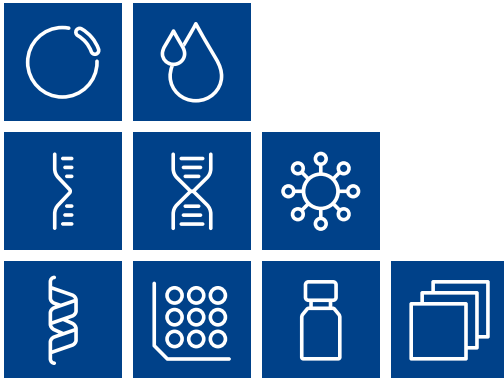

www.mn-net.com

MACHEREY-NAGEL



MACHEREY-NAGEL GmbH & Co. KG
Valenciennener Str. 11
52355 Düren · Germany

DE Tel.: +49 24 21 969-0
CH Tel.: +41 62 388 55 00
FR Tel.: +33 388 68 22 68
US Tel.: +1 888 321 62 24

info@mn-net.com
sales-ch@mn-net.com
sales-fr@mn-net.com
sales-us@mn-net.com

A054387/1110.1